

HRMC(M)13

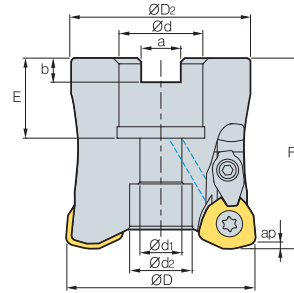

(mm)

Designation		ØD	ØD ₂	Ød	Ød ₁	Ød ₂	a	b	E	F	ap		Bolt	
HRMC (HRMCM)	13050HR-3	3	50	47	22.225 (22)	11	16.4	8.0 (10.4)	5 (6.3)	20 (21)	50	2.0	0.4	SB1035
	13050HR-4	4	50	47	22.225 (22)	11	16.4	8.0 (10.4)	5 (6.3)	20 (21)	50	2.0	0.4	SB1035
	13063HR-4	4	63	60	22.225 (22)	11	17	8.0 (10.4)	5 (6.3)	20 (21)	50	2.0	0.7	SB1035
	13080HR-5	5	80	76	31.75 (27)	18 (13)	26 (20)	12.7 (12.4)	8 (7)	32 (23)	70	2.0	1.6	SB16 (12)45

()Metric size

Available inserts

WDKT-MH



Designation	Cermet		Coated										Uncoated			page			
	CN2000	CN30	NCM325	NC5330	NCM535	NCM545	PC2505	PC2510	PC3600	PC3700	PC6510	PC9530	PC9540	PC5300	PC5400		ST30A	G10	H01
WDKT 130520ZDSR-MH							●	●	●		●	●		●	●				E27

Available arbors

Designation	HRMDC	HRMDCM
HRMC (HRMCM)	13050HR-3	
	13050HR-4	BT□□-FMA22.225-□□ SK□□-FMC22-□□
	13063HR-4	
13080HR-5	BT□□-FMA31.75-□□ SK□□-FMA31.75-□□	BT□□-FMC27-□□ SK□□-FMC27-□□

Bolt

Fig. 1

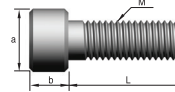
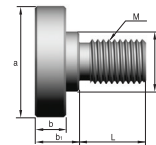

Fig. 2



Designation	Dimensions (mm)							Fig.
	M	a	b	b1	C	L	pitch	
SB1035	M10	16	10	-	-	35	1.5	1
SB1245	M12	18	12	-	-	45	1.75	1
SB1645	M16	24	16	-	-	45	2.0	1
SB2040	M20	30	20	-	-	40	2.5	1
MBA-M20	M20	50	14	20	27	30	2.5	2
MBA-M24	M24	65	14	24	37	36	3.0	2

Parts

Specification					
Ø50-Ø80	FTGA0513-P	CHH4.5R1	CTX04513H	CR03	TW20-100

Available inserts E27 Available arbors and bolt E400-E402

